

**リングジョイント**

適用接続管：銅管、ステンレス管、アルミパイプ管  
 サイズ範囲： 3~ 16、 1/8~ 5/8  
 使用圧力：最高7.0MPa 常用3.5MPa  
 製品材質：JIS H3250 C3604/C3771 (カドミウム75ppm以下保証材)

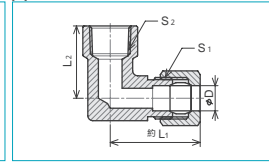
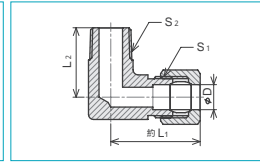
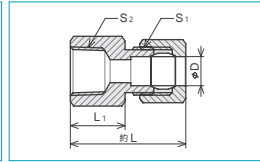
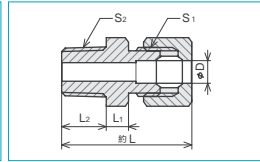

**RMCおねじコネクタ**

**RFCめねじコネクタ**

**RMLおねじエルボコネクタ**

**RFLめねじエルボコネクタ**

呼称 D x S <sub>2</sub>	品番	価格	約L	L <sub>2</sub>
3 x 1/8	RMC-03818	334	28	9
3 x 1/4	RMC-03828	372	32	12
4 x 1/8	RMC-04818	338	28	9
4 x 1/4	RMC-04828	376	32	12
5 x 1/8	RMC-05818	338	28	9
5 x 1/4	RMC-05828	376	32	12
6 x 1/8	RMC-06818	417	33	9
6 x 1/4	RMC-06828	462	36	12
6 x 3/8	RMC-06838	545	39	13
8 x 1/8	RMC-08818	424	33	9
8 x 1/4	RMC-08828	469	36	12
8 x 3/8	RMC-08838	552	39	13
10 x 1/4	RMC-10828	566	40	12
10 x 3/8	RMC-10838	569	41	13
10 x 1/2	RMC-10848	683	46	16
12 x 3/8	RMC-12838	794	47	13
12 x 1/2	RMC-12848	886	50	16
14 x 3/8	RMC-14838	809	48	13
14 x 1/2	RMC-14848	902	51	16
15 x 3/8	RMC-15838	966	50	13
15 x 1/2	RMC-15848	1,120	54	16
16 x 3/8	RMC-16838	975	50	13
16 x 1/2	RMC-16848	1,129	54	16
1/8 x 1/8	RMC-81818	334	28	9
1/8 x 1/4	RMC-81828	372	32	12
1/4 x 1/8	RMC-82818	417	33	9
1/4 x 1/4	RMC-82828	462	36	12
1/4 x 3/8	RMC-82838	545	39	13
3/8 x 1/4	RMC-83828	563	41	12
3/8 x 3/8	RMC-83838	569	42	13
3/8 x 1/2	RMC-83848	683	47	16
1/2 x 3/8	RMC-84838	803	48	13
1/2 x 1/2	RMC-84848	895	51	16
5/8 x 3/8	RMC-85838	975	50	13
5/8 x 1/2	RMC-85848	1,129	54	16

品番	価格	約L	L <sub>1</sub>
RFC-03818	420	26	12
RFC-03828	470	29	15
RFC-04818	423	26	12
RFC-04828	473	29	15
RFC-05818	423	26	12
RFC-05828	473	29	15
RFC-06818	477	30	12
RFC-06828	533	33	15
RFC-06838	667	37	19
RFC-08818	483	30	12
RFC-08828	540	33	15
RFC-08838	673	37	19
RFC-10828	660	35	15
RFC-10838	760	39	19
RFC-10848	1,036	42	22
RFC-12838	993	43	19
RFC-12848	1,017	46	22
RFC-14838	1,011	44	19
RFC-14848	1,225	47	22
RFC-15838	1,189	46	19
RFC-15848	1,342	49	22
RFC-16838	1,353	46	19
RFC-16848	1,353	49	22
RFC-81818	420	26	12
RFC-81828	470	29	15
RFC-82818	477	30	12
RFC-82828	533	33	15
RFC-82838	667	37	19
RFC-83828	660	36	15
RFC-83838	702	40	19
RFC-83848	1,140	43	22
RFC-84838	1,004	44	19
RFC-84848	1,218	47	22
RFC-85838	1,320	46	19
RFC-85848	1,353	49	22

品番	価格	約L <sub>1</sub>	L <sub>2</sub>
RML-03818	620	25	20
RML-03828	820	27	25
RML-04818	624	25	20
RML-04828	824	27	25
RML-05818	624	25	20
RML-05828	824	27	25
RML-06818	733	31	22
RML-06828	733	31	25
RML-06838	1,075	33	28
RML-08818	740	31	22
RML-08828	740	31	25
RML-08838	1,083	33	28
RML-10828	1,124	35	27
RML-10838	1,124	35	28
RML-10848	1,369	38	34
RML-12838	1,489	42	31
RML-12848	1,489	42	34
RML-14838	1,505	43	31
RML-14848	1,505	43	34
RML-15838	1,723	45	31
RML-15848	1,880	45	34
RML-16838	1,891	45	31
RML-16848	1,891	45	34
RML-81818	620	25	20
RML-81828	820	27	25
RML-82818	800	31	22
RML-82828	814	31	25
RML-82838	1,140	33	28
RML-83828	1,236	36	27
RML-83838	1,271	36	28
RML-83848	1,369	39	34
RML-84838	1,498	43	31
RML-84848	1,498	43	34
RML-85838	1,733	45	31
RML-85848	1,891	45	34

品番	価格	約L <sub>1</sub>	L <sub>2</sub>
RFL-03818	620	25	21
RFL-03828	820	27	26
RFL-04818	624	25	21
RFL-04828	824	27	26
RFL-05818	624	25	21
RFL-05828	824	27	26
RFL-06818	880	31	23
RFL-06828	880	31	26
RFL-06838	1,267	33	29
RFL-08818	888	31	23
RFL-08828	888	31	26
RFL-08838	1,435	33	29
RFL-10828	1,236	35	28
RFL-10838	1,545	35	29
RFL-10848	1,978	38	35
RFL-12838	2,151	42	32
RFL-12848	2,151	42	35
RFL-14838	2,173	43	32
RFL-14848	2,173	43	35
RFL-15838	2,298	45	32
RFL-15848	2,298	45	35
RFL-16838	2,311	45	32
RFL-16848	2,311	45	35
RFL-81818	620	25	21
RFL-81828	820	27	26
RFL-82818	880	31	23
RFL-82828	880	31	26
RFL-82838	1,326	33	29
RFL-83828	1,236	36	28
RFL-83838	1,545	36	29
RFL-83848	1,780	39	35
RFL-84838	2,164	43	32
RFL-84848	2,164	43	35
RFL-85838	2,311	45	32
RFL-85848	2,311	45	35

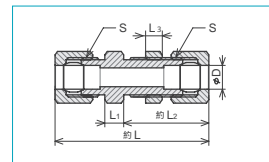
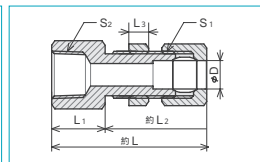
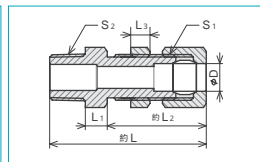

**RMB隔壁型おねじコネクタ**

**RFB隔壁型めねじコネクタ**

**RUB隔壁型ユニオン**

呼称 D x S <sub>2</sub>	品番	価格	約L	約L <sub>2</sub>
3 x 1/8	RMB-03818	692	42	28
4 x 1/8	RMB-04818	696	42	28
5 x 1/8	RMB-05818	696	42	28
6 x 1/4	RMB-06828	900	49	31
8 x 1/4	RMB-08828	908	49	31
10 x 3/8	RMB-10838	1,073	56	35
12 x 1/2	RMB-12848	1,394	72	46
14 x 1/2	RMB-14848	1,409	73	47
1/8 x 1/8	RMB-81818	692	42	28
1/4 x 1/4	RMB-82828	900	49	31
3/8 x 3/8	RMB-83838	1,073	57	36
1/2 x 1/2	RMB-84848	1,403	73	47

品番	価格	約L	約L <sub>2</sub>
RFB-03818	709	40	28
RFB-04818	713	40	28
RFB-05818	713	40	28
RFB-06828	876	46	31
RFB-08828	884	46	31
RFB-10838	1,120	54	35
RFB-12848	1,551	68	46
RFB-14848	1,566	69	47
RFB-81818	709	40	28
RFB-82828	803	46	31
RFB-83838	1,120	55	36
RFB-84848	1,560	69	47

呼称 D	品番	価格	約L	約L <sub>2</sub>
3	RUB-03008	695	47	28
4	RUB-04008	702	47	28
5	RUB-05008	702	47	28
6	RUB-06008	898	54	31
8	RUB-08008	957	54	31
10	RUB-10008	1,194	63	35
12	RUB-12008	1,797	80	46
14	RUB-14008	1,920	82	47
1/8	RUB-81008	695	47	28
1/4	RUB-82008	898	54.5	31
3/8	RUB-83008	1,194	65	36
1/2	RUB-84008	1,816	82	47



1  
 空気・油圧・真空  
 直動システム・関連  
 ロボット・F.A  
 制御・検出・計測  
 駆動・回転  
 軸受・素材・機械  
 動力伝達・伝動  
 搬送・運搬  
 ポンプ・送風機・粉体  
 工場設備・環境