

軸穴加工付スプロケットホイール

DKSチェーン歯車工業

204651

FBN40型軸穴加工付スプロケットホイール(新JISキー溝対応)

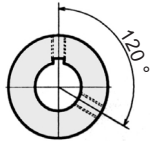
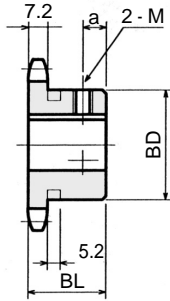

形番	穴 D キー溝 押ねじ	10	12	14	15	16	17	18	19	20	22
		3 × 1.4	4 × 1.8	5 × 2.3	5 × 2.3	5 × 2.3	5 × 2.3	6 × 2.8	6 × 2.8	6 × 2.8	6 × 2.8
FBN40B10	930	930	930	930	930	1,020	1,020	1,020			
FBN40B11	1,020	1,020	1,020	1,020	1,020	1,020	1,020	1,060	1,060	1,060	
FBN40B12	1,020	1,020	1,020	1,020	1,020	1,020	1,020	1,020	1,020	1,020	1,150
FBN40B13		1,060	1,060	1,060	1,060	1,060	1,060	1,060	1,060	1,060	1,150
FBN40B14		1,100	1,100	1,100	1,100	1,100	1,100	1,100	1,100	1,100	1,240
FBN40B15		1,100	1,100	1,100	1,100	1,100	1,100	1,100	1,100	1,100	1,240
FBN40B16			1,100	1,100	1,100	1,100	1,100	1,100	1,100	1,100	1,280
FBN40B17			1,150	1,150	1,150	1,150	1,150	1,150	1,150	1,150	1,320
FBN40B18			1,240	1,240	1,240	1,240	1,240	1,240	1,240	1,240	1,410
FBN40B19			1,280	1,280	1,280	1,280	1,280	1,280	1,280	1,280	1,540
FBN40B20			1,370	1,370	1,370	1,370	1,370	1,370	1,370	1,370	1,540
FBN40B21			1,630	1,630	1,630	1,630	1,630	1,630	1,630	1,630	1,630
FBN40B22			1,680	1,680	1,680	1,680	1,680	1,680	1,680	1,680	1,680
FBN40B23			1,680	1,680	1,680	1,680	1,680	1,680	1,680	1,680	1,680
FBN40B24			1,680	1,680	1,680	1,680	1,680	1,680	1,680	1,680	1,680
FBN40B25			1,680	1,680	1,680	1,680	1,680	1,680	1,680	1,680	1,680
FBN40B26			1,720	1,720	1,720	1,720	1,720	1,720	1,720	1,720	1,720
FBN40B27			1,810	1,810	1,810	1,810	1,810	1,810	1,810	1,810	1,810
FBN40B28			1,850	1,850	1,850	1,850	1,850	1,850	1,850	1,850	1,850
FBN40B29											
FBN40B30			1,900	1,900	1,900	1,900	1,900	1,900	1,900	1,900	1,900
FBN40B31											
FBN40B32										2,160	2,160
FBN40B33											
FBN40B34										2,250	2,250
FBN40B35										2,250	2,250
FBN40B36										2,290	2,290
FBN40B37											
FBN40B38											
FBN40B39											
FBN40B40											

ボス径・ボス幅はB型と同じです。旧JISキー溝対応品、丸穴加工対応品も即納です。ご用命願います。

●形番の表示 FBN 40 B 20 - D20

FBN : 新JISキー溝対応
チェーンNo. ボス形状
歯数 軸穴径

●材質:S35C歯先高周波焼入

軸穴寸法表

軸穴径 D	キー溝 b × t ₂	タップ
10H7	3 × 1.4	2-M4
12H7	4 × 1.8	2-M5
14H7	5 × 2.3	2-M6
15H7	5 × 2.3	2-M6
16H7	5 × 2.3	2-M6
17H7	5 × 2.3	2-M6
18H7	6 × 2.8	2-M6
19H7	6 × 2.8	2-M6
20H7	6 × 2.8	2-M6
22H7	6 × 2.8	2-M6
24H7	8 × 3.3	2-M8
25H7	8 × 3.3	2-M8
28H7	8 × 3.3	2-M8
30H7	8 × 3.3	2-M8
32H7	10 × 3.3	2-M8
35H7	10 × 3.3	2-M8
38H7	10 × 3.3	2-M8
40H7	12 × 3.3	2-M8
42H7	12 × 3.3	2-M8
45H7	14 × 3.8	2-M10

形番	穴 D キー溝 押ねじ	24	25	28	30	32	35	38	40	42	45
		8 × 3.3	8 × 3.3	8 × 3.3	8 × 3.3	10 × 3.3	10 × 3.3	10 × 3.3	12 × 3.3	12 × 3.3	14 × 3.8
FBN40B10											
FBN40B11											
FBN40B12											
FBN40B13	1,150	1,150									
FBN40B14	1,240	1,240	1,240								
FBN40B15	1,240	1,240	1,240	1,240							
FBN40B16	1,280	1,280	1,280	1,280	1,410						
FBN40B17	1,320	1,320	1,320	1,320	1,500	1,500					
FBN40B18	1,410	1,410	1,410	1,410	1,540	1,540		1,540			
FBN40B19	1,540	1,540	1,540	1,540	1,680	1,680	1,680	1,680			
FBN40B20	1,540	1,540	1,540	1,540	1,680	1,680	1,680	1,680	1,680	1,680	1,680
FBN40B21	1,630	1,630	1,630	1,630	1,720	1,720	1,720	1,720	1,720	1,850	1,850
FBN40B22	1,680	1,680	1,760	1,760	1,760	1,760	1,760	1,760	1,760	1,900	1,900
FBN40B23	1,680	1,680	1,760	1,760	1,760	1,760	1,760	1,760	1,760	1,900	1,900
FBN40B24	1,680	1,680	1,760	1,760	1,760	1,760	1,760	1,760	1,760	1,900	1,900
FBN40B25	1,680	1,680	1,760	1,760	1,760	1,760	1,760	1,760	1,760	1,900	1,900
FBN40B26	1,720	1,720	1,720	1,720	1,940	1,940	1,940	1,940	1,940	2,030	2,030
FBN40B27	1,810	1,810	1,810	1,810	1,980	1,980	1,980	1,980	1,980	2,160	2,160
FBN40B28	1,850	1,850	1,850	1,850	2,030	2,030	2,030	2,030	2,030	2,200	2,200
FBN40B29		1,940									
FBN40B30	1,900	1,900	1,900	1,900	2,070	2,070	2,070	2,070	2,070	2,250	2,250
FBN40B31											
FBN40B32	2,160	2,160	2,160	2,160	2,250	2,250			2,250		
FBN40B33											
FBN40B34	2,250	2,250	2,250	2,250	2,420	2,420			2,420		
FBN40B35	2,250	2,250	2,250	2,250	2,420	2,420			2,420		
FBN40B36	2,290	2,290	2,290	2,290	2,510	2,510			2,510		
FBN40B37						2,560					
FBN40B38	2,470	2,470	2,470	2,470	2,560	2,560			2,560		
FBN40B39											
FBN40B40		2,730	2,730	2,730	2,730	2,730			2,730		

ボス径・ボス幅はB型と同じです。旧JISキー溝対応品、丸穴加工対応品も即納です。ご用命願います。



空圧・油圧・真空

直動システム・関連

ロボット・FA

制御・検出・計測

駆動・回転

軸受・素材・機械

動力伝達・伝動

搬送・運搬

ポンプ・送風機・粉体

工場設備・環境