

標準ステンレスプロケットホイール

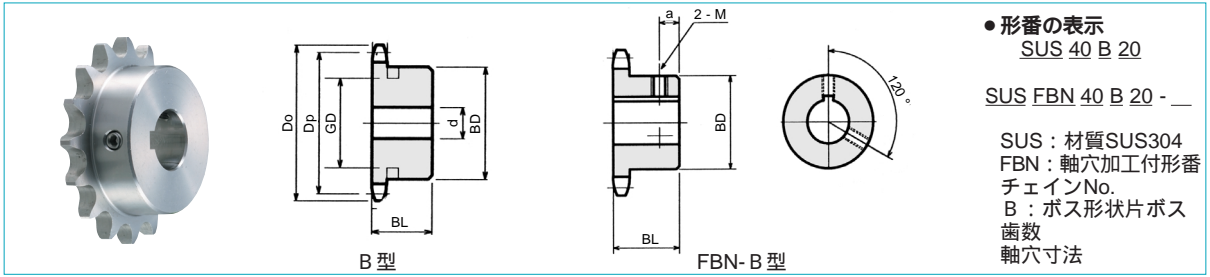

SUS40B型

SUSFBN40B型軸穴加工付スプロケットホイール(新JISキー対応)

形番	価格		ボス	
	B型	径BD	幅BL	
40B10	1,630	32	22	
40B11	1,810	36	22	
40B12	1,850	40	22	
40B13	2,040	37	22	
40B14	2,280	42	22	
40B15	2,530	46	22	
40B16	2,770	50	22	
40B17	2,810	54	22	
40B18	3,150	57	22	
40B19	3,410	62	22	
40B20	4,000	67	25	
40B21	5,220	71	25	
40B22	4,840	75	25	
40B23	4,900	77	25	
40B24	5,090	63	25	
40B25	5,520	63	25	
40B26	6,920	63	25	
40B27	7,500	63	25	
40B28	7,760	63	25	
40B30	7,100	63	25	
40B32	9,350	68	28	
40B34	10,300	68	28	
40B35	10,800	68	28	
40B36	11,200	68	28	
40B38	11,700	68	28	
40B40	11,800	68	28	

形番	キー溝押ねじ	穴 D		15	16	18	19	20	22	24	25	28	30
		5×2.3	6×2.8										
FBN40B10	2-M6	3,180	3,180										
FBN40B11	2-M6	3,460	3,460					3,460					
FBN40B12	2-M6	3,630	3,630			3,630		3,630					
FBN40B13	2-M6	3,820	3,820			3,820		3,820					
FBN40B14	2-M6	4,020	4,020			4,020	4,020	4,020	4,020	4,020			
FBN40B15	2-M6	4,380	4,380			4,380	4,380	4,380	4,380	4,380	4,380		
FBN40B16	2-M6	4,670	4,670			4,670	4,670	4,670	4,670	4,670	4,670	4,670	4,670
FBN40B17	2-M6	4,840	4,840			4,840	4,840	4,840	4,840	4,840	4,840	4,840	4,840
FBN40B18	2-M6	5,130	5,130			5,130	5,130	5,130	5,130	5,130	5,130	5,130	5,130
FBN40B19	2-M6	5,330	5,330			5,330	5,330	5,330	5,330	5,330	5,330	5,330	5,330
FBN40B20	2-M6	5,810	5,810			5,810	5,810	5,810	5,810	5,810	5,810	5,810	5,810
FBN40B21	2-M6					6,360		6,360	6,360	6,360	6,360	6,360	6,360
FBN40B22	2-M6					6,840		6,840	6,840	6,840	6,840	6,840	6,840
FBN40B23	2-M6					7,540		7,540	7,540	7,540	7,540	7,540	7,540
FBN40B24	2-M6					7,720		7,720	7,720	7,720	7,720	7,720	7,720
FBN40B25	2-M6					7,850		7,850	7,850	7,850	7,850	7,850	7,850
FBN40B26	2-M6							8,470	8,470				8,470
FBN40B28	2-M6							8,970	8,970		8,970		8,970
FBN40B30	2-M6							9,280	9,280		9,280		9,280
FBN40B32	2-M6							10,540	10,540		10,540		10,540
FBN40B35	2-M6							11,190	11,190		11,190		11,190
FBN40B36	2-M6							12,210	12,210		12,210		12,210
FBN40B40	2-M6							13,200	13,200		13,200		13,200

SUS50B型

SUSFBN50B型軸穴加工付スプロケットホイール(新JISキー対応)

形番	価格		ボス	
	B型	径BD	幅BL	
50B10	2,170	40	25	
50B11	2,380	45.5	25	
50B12	2,660	50	25	
50B13	2,980	51	25	
50B14	3,990	52	25	
50B15	3,680	57	25	
50B16	4,000	62	25	
50B17	4,750	67	25	
50B18	5,440	72	28	
50B19	7,480	73	28	
50B20	6,390	73	28	
50B21	8,820	73	28	
50B22	9,120	73	28	
50B23	9,380	73	28	
50B24	8,180	73	28	
50B25	10,400	73	28	
50B26	10,700	73	28	
50B27	11,500	73	28	
50B28	11,600	73	28	
50B30	12,000	73	28	
50B32	13,500	73	28	
50B34	15,000	73	28	
50B35	15,800	73	28	
50B36	16,500	82	35	
50B38	17,500	82	35	
50B40	18,000	82	35	

形番	キー溝押ねじ	穴 D		20	22	24	25	28	30	32	35	38	40
		6×2.8	8×3.3										
FBN50B10	2-M6	4,130	4,130										
FBN50B11	2-M6	4,490	4,490			4,490	4,490						
FBN50B12	2-M6	4,880	4,880			4,880	4,880						
FBN50B13	2-M6	4,990	4,990			4,990	4,990						
FBN50B14	2-M6	5,370	5,370			5,370	5,370	5,370	5,370				
FBN50B15	2-M6	5,740	5,740			5,740	5,740	5,740	5,740	5,740			
FBN50B16	2-M6	6,030	6,030			6,030	6,030	6,030	6,030	6,030			
FBN50B17	2-M6	6,420	6,420			6,420	6,420	6,420	6,420	6,420	6,420	6,420	6,420
FBN50B18	2-M6	7,180	7,180			7,180	7,180	7,180	7,180	7,180	7,180	7,180	7,180
FBN50B19	2-M6	7,680	7,680			7,680	7,680	7,680	7,680	7,680	7,680	7,680	7,680
FBN50B20	2-M6	7,950	7,950			7,950	7,950	7,950	7,950	7,950	7,950	7,950	7,950
FBN50B21	2-M6	8,820				8,820		8,820		8,820		8,820	8,820
FBN50B22	2-M6	9,020				9,020		9,020		9,020		9,020	9,020
FBN50B23	2-M6	9,370				9,370		9,370		9,370		9,370	9,370
FBN50B24	2-M6	9,840				9,840		9,840		9,840		9,840	9,840
FBN50B25	2-M6	10,060				10,060		10,060		10,060		10,060	10,060
FBN50B26	2-M6	11,430				11,430		11,430		11,430		11,430	11,430
FBN50B28	2-M6	11,540				11,540		11,540		11,540		11,540	11,540
FBN50B30	2-M6	11,760				11,760		11,760		11,760		11,760	11,760
FBN50B32	2-M6					12,540		12,540		12,540		12,540	12,540
FBN50B35	2-M6						13,500		15,320		15,320		15,320

空圧・油圧・真空

直動システム・閉鎖

ロボット・FA

制御・検出・計測

駆動・回転

軸受・素材・機械

動力伝達・伝動

搬送・運搬

ポンプ・送風機・粉体

工場設備・環境